

# Gear Series **GB380CP**



## Spur Reduction Gearhead - 0.5 Nm

### Design

Gearhead GB380CP is a multi step gearhead with all polyacetal gears which rotate on steel spindles which are polished to a mirror-finish and introduced between metal plates with a plastic frame. All bearings are permanently lubricated and therefore require no maintenance. Thicker shafts ( $\varnothing 6-7\text{mm}$ ) mounted in robust bushings ( $\varnothing 12$ ) are available. Similarly the gears at the output end can be metal (GB380CPH) with thick shafts ( $\varnothing 6-7\text{mm}$ ) & robust bushings. Sintered gears variant also possible (GB380CSi).

### Standard Data

Gear Type		Spur
Gear Torque	Nm	0.5
Combination with Mechtex motors		small DC motors up to dia. 35mm (DC28/30/32) & MTR3a/3b, MTS3a/3b
Mounting		any position
Weight	g	55
Axial thrust	N	20
Lateral force	N	60
Radial torque	Nm	0.6
Output bearing		Brass sleeve bushings, Sintered bronze (on request)
Output shafts	$\varnothing$	all shafts same as GB5P gear series
Ambient temperature operation	$^{\circ}\text{C}$	-15...+55
Enclosure	IP	30

### Transmission Ratios

For Transmission Ratios refer to page nos. 6 & 7.

### Dimensional Drawing

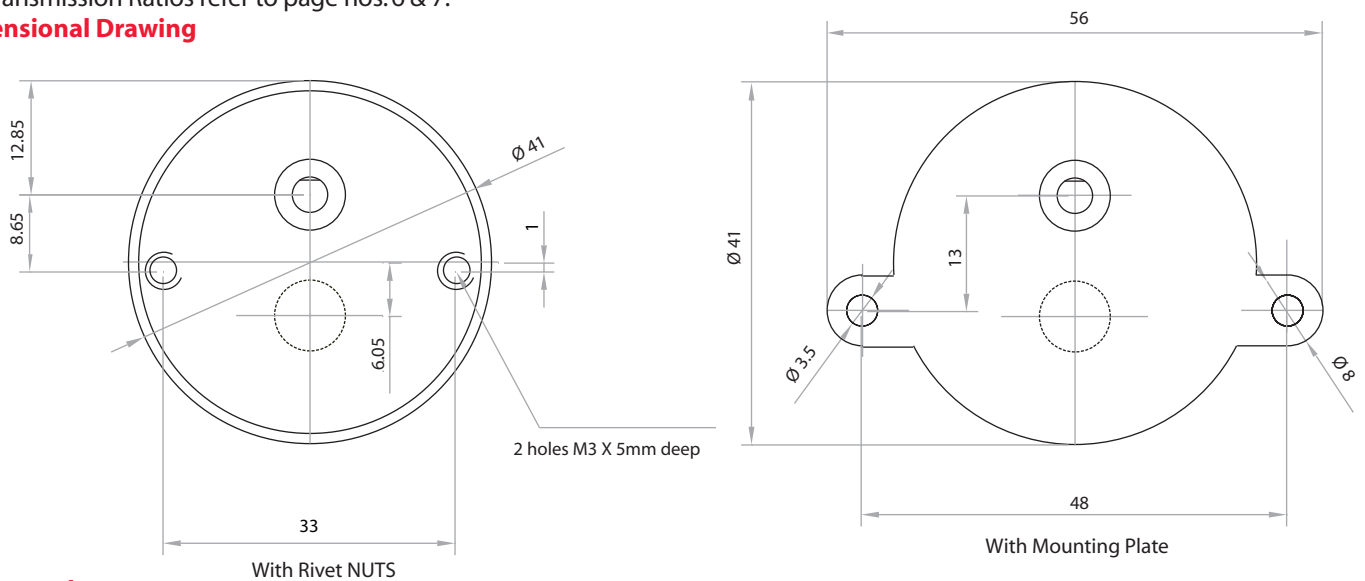

### Photographs

